

FYTB 35 TR

Housing material

Cast iron

Dimensions

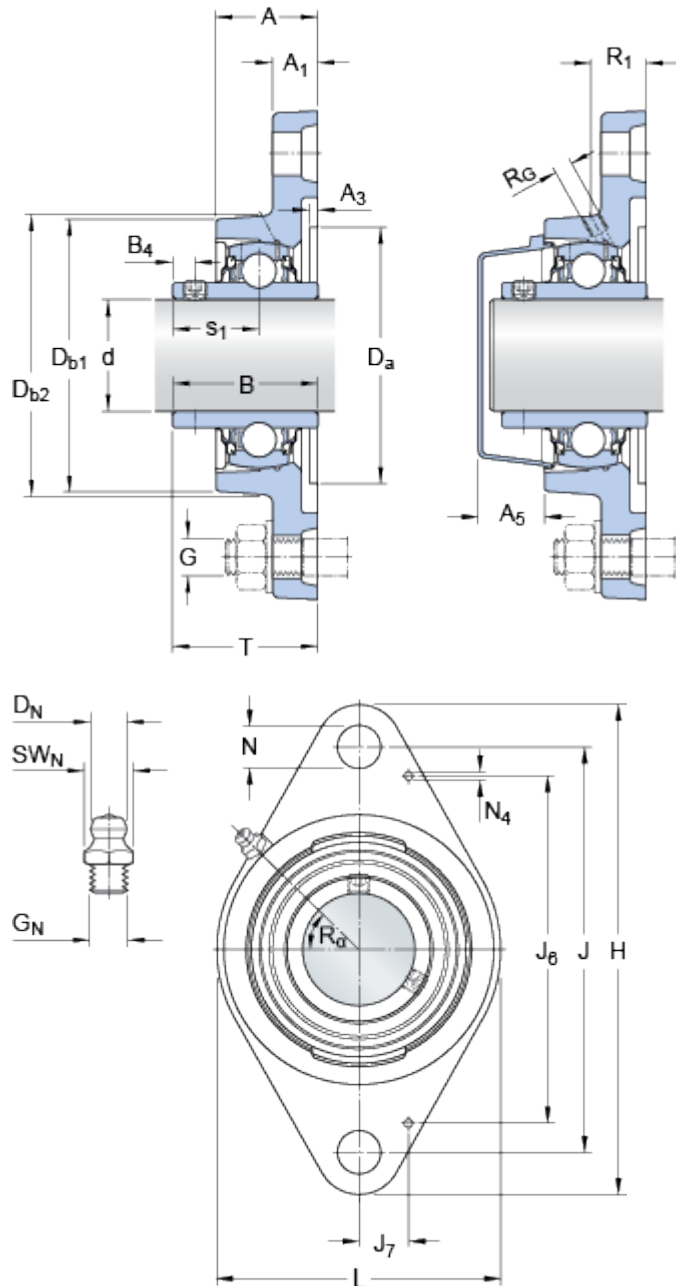

d		35	mm
A		34.5	mm
A ₁		13	mm
A ₃	H14	3.2	mm
A ₅		22	mm
B		42.9	mm
B ₄		6	mm
D _a	H11	88.9	mm
D _{b1}		88	mm
D _{b2}		96	mm
J		130	mm
H		156	mm
L		96	mm
N		14	mm
s ₁		25.4	mm
T		46.4	mm

Dowel pins

J ₆		106	mm
J ₇		15	mm
N ₄		2	mm

Grease fitting

D _N		6.5	mm
SW _N		7	mm
G _N		1/4-28 SAE-LT	

Threaded hole

R_G	1/4-28 UNF
R_1	22 mm
R_a	45 °

Calculation data

Basic dynamic load rating	C	25.5	kN
Basic static load rating	C_0	15.3	kN
Fatigue load limit	P_u	0.655	kN
Limiting speed		3200	r/min

(with shaft tolerance h6)

Mass

Mass bearing unit	1.15	kg
-------------------	------	----

Mounting information

Thread grub screw	G_2	M6x0.75	
Hexagonal key size for grub screw	N	3	mm
Recommended tightening torque for grub screw		4	N·m
Recommended diameter for attachment bolts, mm	G	12	mm
Recommended diameter for attachment bolts, inch	G	0.5	in

Appertaining products

Housing	FYTB 507 M
Bearing	YAR 207-2RF

Appropriate products

End cover	ECY 207
-----------	---------